



Property/Location

Site Name: L&C Tract A
Community: Chester
County: Chester

Physical Characteristics

Lease: No
Size: 330 acres/134 hectares
Total Certified Acres:
Subdividable: Yes
Price Per Acre:
Price Range: \$8,000 to \$12,000
Soil Type: Loamy Sand, Sandy Clay
Elevation Range: 480 to 500 feet

Transportation Access

Interstate(s): I-77: 9 miles/15 km; I-20: 54 miles/87 km
Commercial Airport: Charlotte-Douglas International: 43 miles/70 km
Private Airport: Chester Catawba Regional Airport: 8 miles/13 km
Rail: Lancaster and Chester Railway
Container Port: Charleston: 166 miles/267 km



Community Information

Subject Property Inside City Limits: No
School District: Chester
Tax District: District 2
Community Development Status: Under Developed
Foreign Trade Zone: No
Multicounty Industrial Park: Yes
Related Counties: York
Tax Map ID: 89-15
Zoned Industrial: Yes
Zoning or Regulations: ID-2
Current Landuse(s): Dormant
Surrounding Landuse(s): Agricultural, Woodlands

Adjacent Property Available: No

Water Service Provider: Chester Metro. District
Water Main Diameter: 12 inch/30.5 cm
Distance to Water Line: On Site
Comments: West side of site 250 feet

Sewer Service Provider: Chester Sewer District
Sewer Main Diameter: 18 inch/45.7 cm
Sewer Type (Force or Gravity): Gravity
Distance to Sewer Line: On Site
Comments: Sewer line transects site

Natural Gas Provider: Chester Co. Natural Gas
Natural Gas Line Diameter: 6 inch/15.2 cm
Natural Gas Proximity: Available
Comments: 4" and 6" lines on S boundary

Primary Electricity Provider: Duke Energy
Alt. Energy Provider
Comments:

Telecom Provider: Tru Vista Telecomm.
Fiber Optics Provider: Tru Vista Telecomm.
Cable Provider: Tru Vista Telecomm.

Fire Department: Chester City Fire Dept.
Distance to Fire Dept.: 3.4 miles/5.4 km
Fire Dept. ISO Rating: 4

Contact

Chester County Office of Economic Development
525 College Place, Suite A
Chester, SC 29706
803.377.1216
ChooseChester.com

This is a product of the Office of Economic Development for Chester County. The information is derived from various sources and this department does not guarantee its accuracy nor make any representations concerning the suitability of the property for your purpose.



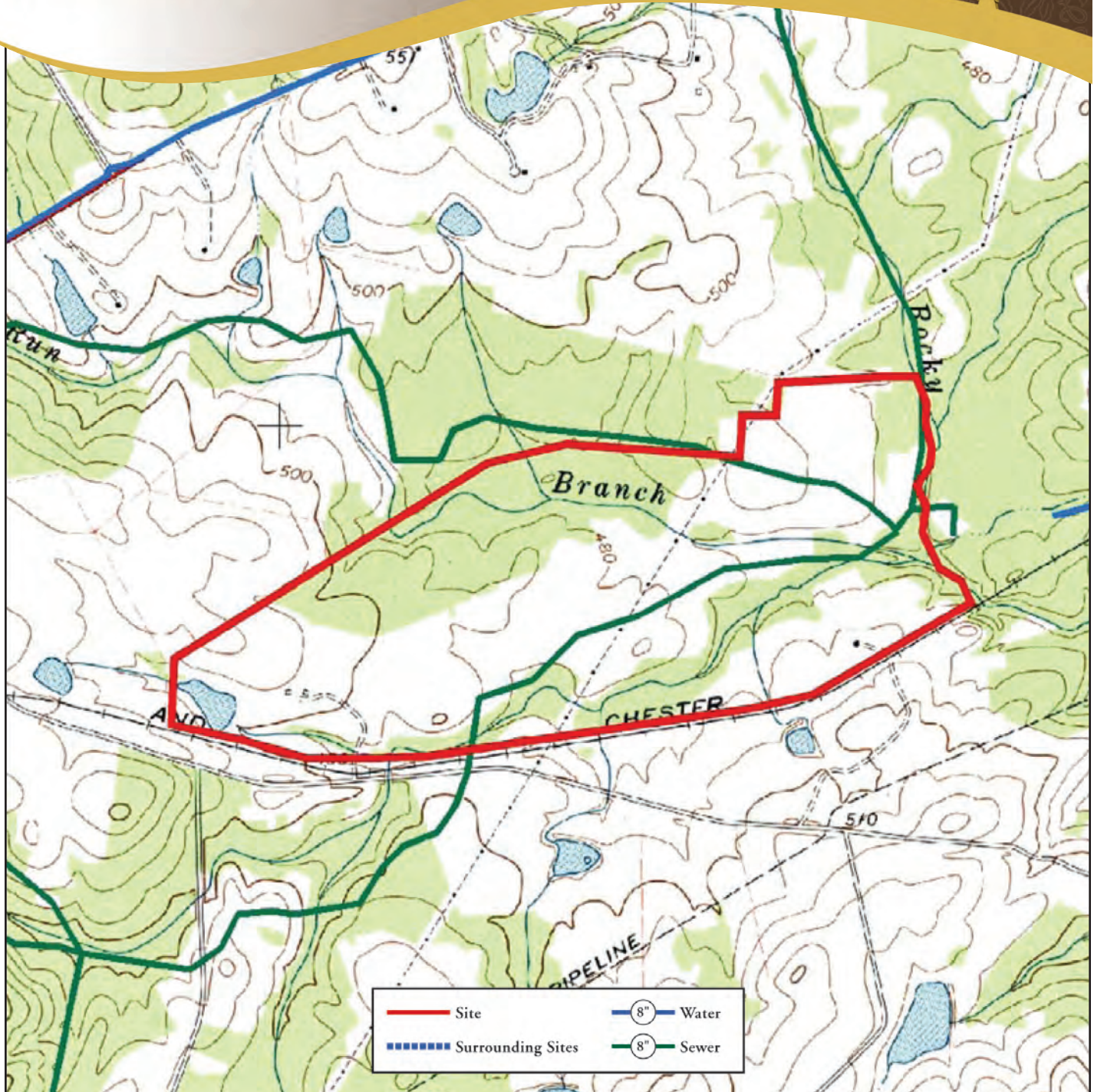

Utilities and Services



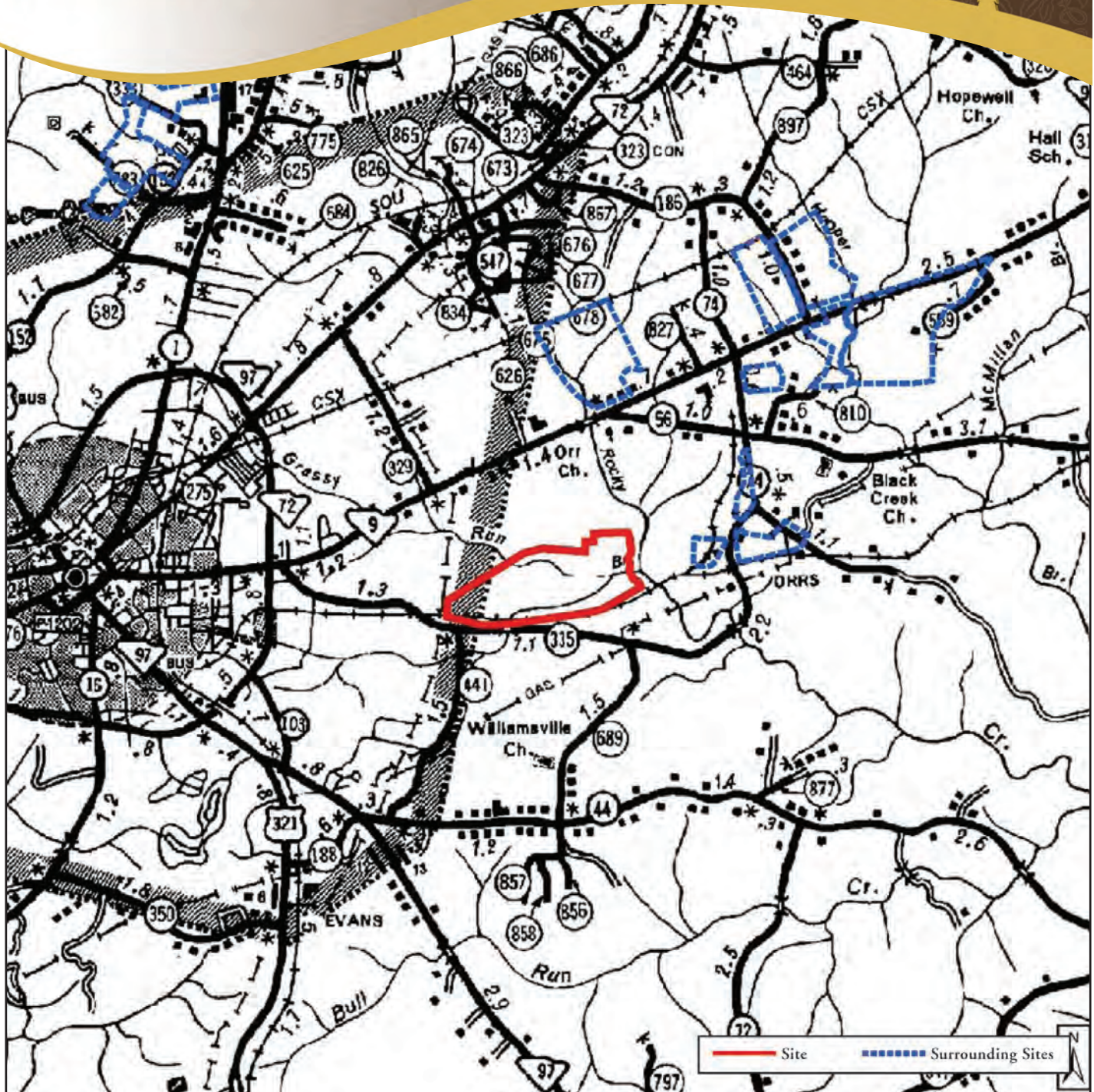

Transportation Map and Surrounding Sites



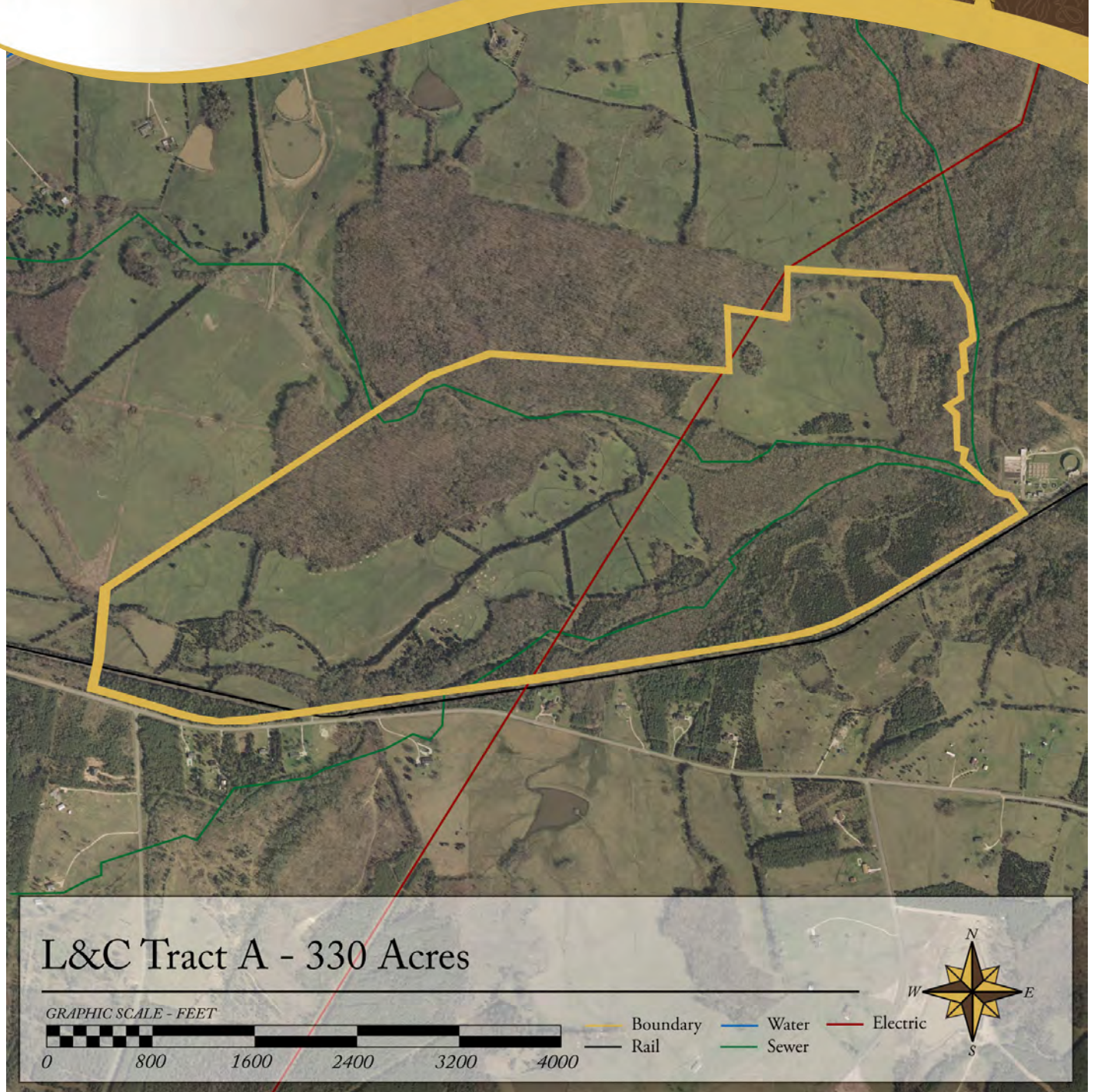

Aerial View

