

# DUKE ENERGY SITE READINESS PROGRAM LAKEMONT BUSINESS PARK

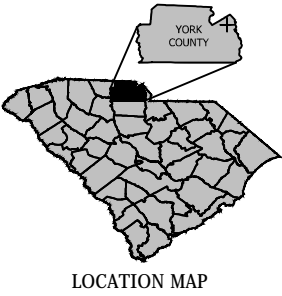

- LEGEND
- OP OVERHEAD POWER
  - STREAM
  - PROPERTY LINE

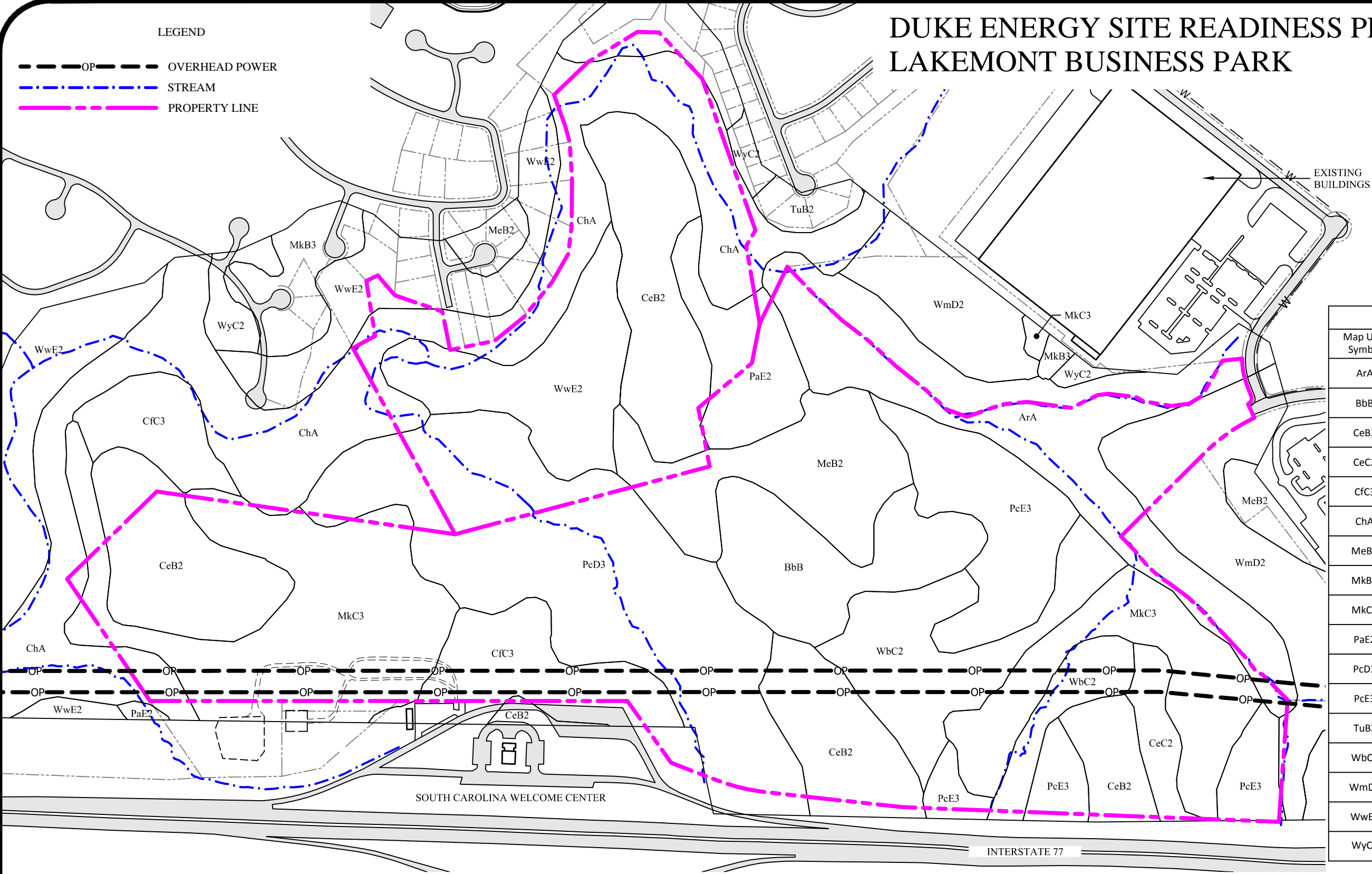

Soils Legend	
Map Unit Symbol	Map Unit Name
ArA	Armenia loam, 0 to 2 percent slopes, occasionally flooded
BbB	Brewback fine sandy loam, 2 to 6 percent slopes
CeB2	Cecil sandy clay loam, 2 to 6 percent slopes, moderately eroded
CeC2	Cecil sandy clay loam, 6 to 10 percent slopes, moderately eroded
CfC3	Cecil clay loam, 6 to 10 percent slopes, severely eroded
ChA	Chewacla loam, 0 to 2 percent slopes, frequently flooded
MeB2	Mecklenburg-Wynott complex, 2 to 6 percent slopes, moderately eroded
MkB3	Mecklenburg-Wynott complex, 2 to 6 percent slopes, severely eroded
MkC3	Mecklenburg-Wynott complex, 6 to 10 percent slopes, severely eroded
PaE2	Pacolet sandy clay loam, 15 to 25 percent slopes, moderately eroded
PcD3	Pacolet clay loam, 10 to 15 percent slopes, severely eroded
PcE3	Pacolet clay loam, 15 to 25 percent slopes, severely eroded
TuB2	Turbeville sandy clay loam, 2 to 6 percent slopes, moderately eroded
WbC2	Wynott-Brewback complex, 6 to 10 percent slopes, moderately eroded
WmD2	Wynott-Mecklenburg complex, 10 to 15 percent slopes, moderately eroded
WwE2	Wynott-Wilkes complex, 15 to 25 percent slopes, moderately eroded
WyC2	Wynott-Winnsboro complex, 6 to 10 percent slopes, moderately eroded

## GRAPHIC SCALE

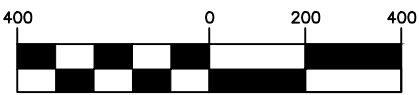

( IN FEET )  
1 inch = 400 ft.



THIS SITE HAS BEEN EVALUATED AS PART OF  
DUKE ENERGY'S SITE READINESS PROGRAM



PREPARED BY:  
CARLISLE ASSOCIATES INC.  
PO BOX 11528  
COLUMBIA, SC 29201  
(803) 252-3232

## EXHIBIT 6 SOILS MAP

AUGUST 22, 2013